

# CAS

고속중실형 파워척

CLOSED CENTER POWER CHUCK

高速中実型パワーチャック / 中実動力卡盘

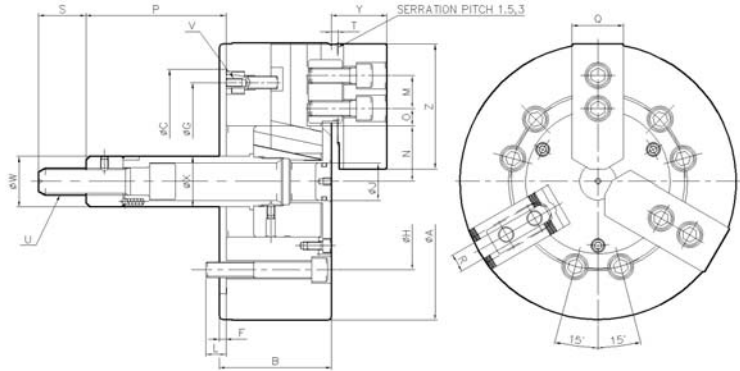

## Dynamic Gripping Force/动夹紧力/動的把握力グラフ/동적파악력 선도

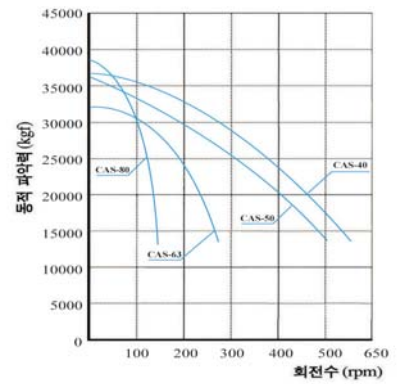
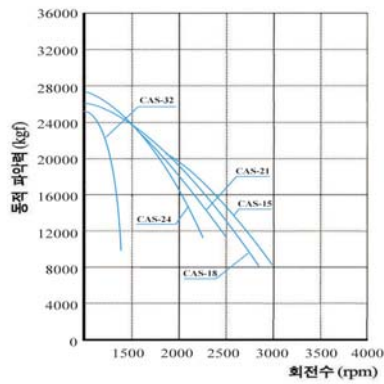
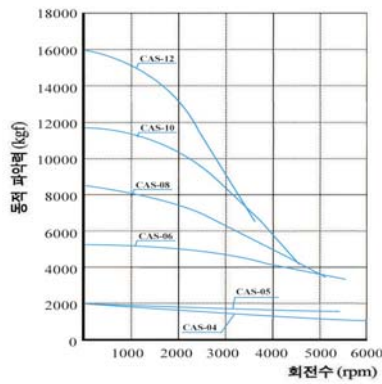

## Dimension/尺寸/寸法表/치수표

Item 항목	A	B	C	F	G	H	J	K	L	M	Nmax	Nmin
Mb del형식												
CAS-04	110	52	60	6	-	80	-	3-M8	16.5	14	26	23.5
CAS-05	135	52	80	7	-	100	-	3-M8	16.5	19	32	29.5
CAS-06	169	74	140	5	116	104.8	23	6-M10	14	20	41	36.7
CAS-08	210	85	170	5	150	133.4	28	6-M12	15	25	46.3	41.9
CAS-10	254	89	220	5	190	171.4	34	6-M16	18	30	51.1	46.7
CAS-12	304	106	220	6	190	171.4	39	6-M16	18	30	61	55.7
CAS-15	381	114	300	6	260	235	27	6-M20	20	43	73	65
CAS-18	450	114	300	6	260	235	27	6-M20	20	43	106.5	98.5
CAS-21	530	125	380	6	330	330.2	27	6-M22	26	60	86	78
CAS-24	610	125	380	6	330	330.2	27	6-M22	26	60	124.5	116.5
CAS-32	800	150	380	6	-	330.2	-	6-M24	31	76.2	88	77.7
CAS-40	1000	180	520	8	-	510	-	6-M24	34	100	145	129.8
CAS-50	1250	180	520	8	-	453.6	-	6-M24	32	100	145	129.8
CAS-63	1600	220	720	8	-	648	-	6-M30	46	-	-	-
CAS-80	2000	250	720	10	-	1120	-	6-M30	58	152.4	-	-

Item 항목	O max	O min	P max	P min	Q	R	S	T	U	V	W	X	Y	Z
Mb del형식														
CAS-04	10	7	5	-10	25	10	25	3	M10X15	-	25	-	27	54
CAS-05	11.5	7	9	-6	25	10	36	3	M12X1.75	-	28	-	27	58.5
CAS-06	13	7	101.5	81.5	31	12	36	4	M16X2.0	3-M6	32	32	35	72
CAS-08	22.5	9	127	106	39	14	36	5	M20X2.5	3-M6	38	38	43	95
CAS-10	30.7	11.2	158	133	44	16	36	5	M20X2.5	3-M8	38	44	50	110
CAS-12	48.7	12.7	163	133	50	18	36	5	M20X2.5	3-M8	38	50	54	111
CAS-15	54.7	15.7	104	69	50	25.5	55	6	M30X3.5	3-M10	55	60	60	135
CAS-18	48.5	23.2	92	57	50	25.5	55	6	M30X3.5	3-M10	55	60	60.3	135
CAS-21	93.5	27.5	97	62	65	25	55	6	M30X3.5	3-M12	55	60	71	180
CAS-24	93.5	27.5	97	62	65	25	55	6	M30X3.5	3-M12	55	60	71	180
CAS-32	-	-	35	-3	75	25.5	60	8	M30X3.5	-	55	114	83	165
CAS-40	-	-	53	-3	98	30	65	-4	M36X4.0	-	60	-	106	200
CAS-50	-	-	35	-22	98	30	68	-4	M36X4.0	-	60	-	106	200
CAS-63	-	-	13	-47	-	-	-	-	M36X4.0	-	-	-	-	-
CAS-80	-	-	23	-37	110	30	68	-4	M42X4.5	-	66	-	105	270

※ CAS-32인치이상은 Soft Jaw체결부가 Key Type입니다.  
 ※ Soft jaw for lager size than CAS-32 : Key Mount Type.

※ 치수 및 사양은 예고없이 변경될 수 있습니다.  
 ※ Specifications are subject to change without notice.